

LaPorte Soccer Club

Kesling School and Kesling Park

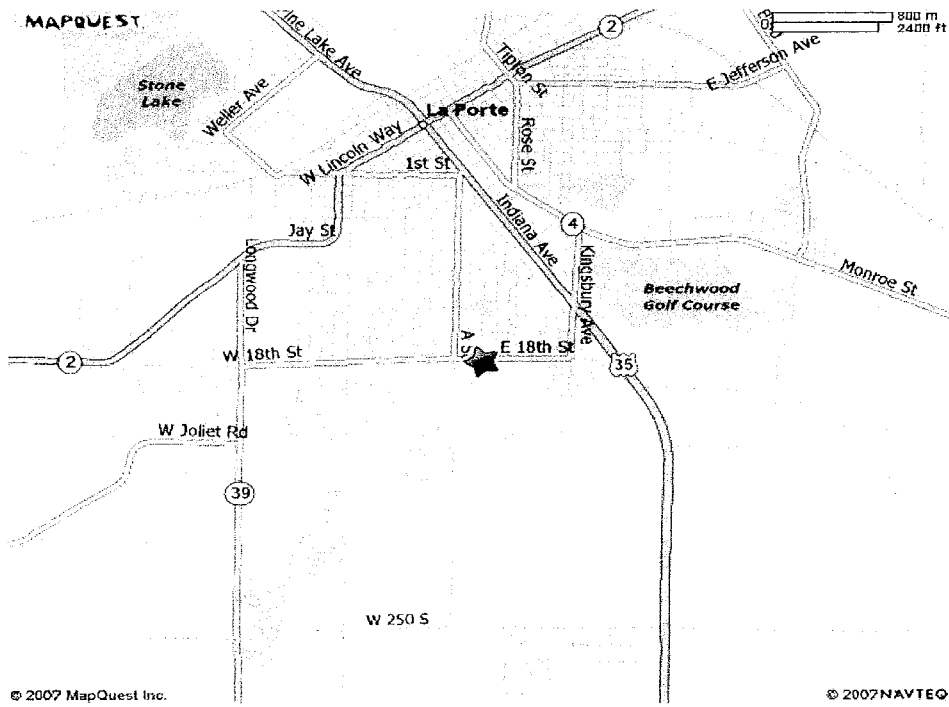

The U14 field is at Kesling School.

U8/U10 & U12 fields are at Kesling Park, just south of the School.

If you come into LaPorte from the West on Highway 2, veer right, onto 18th Street near the LaPorte County Fairgrounds entrance. Continue east on 18th Street to "A" Street.

Kesling School is at the corner of 18th Street and "A" Street

The U14 field is at the school

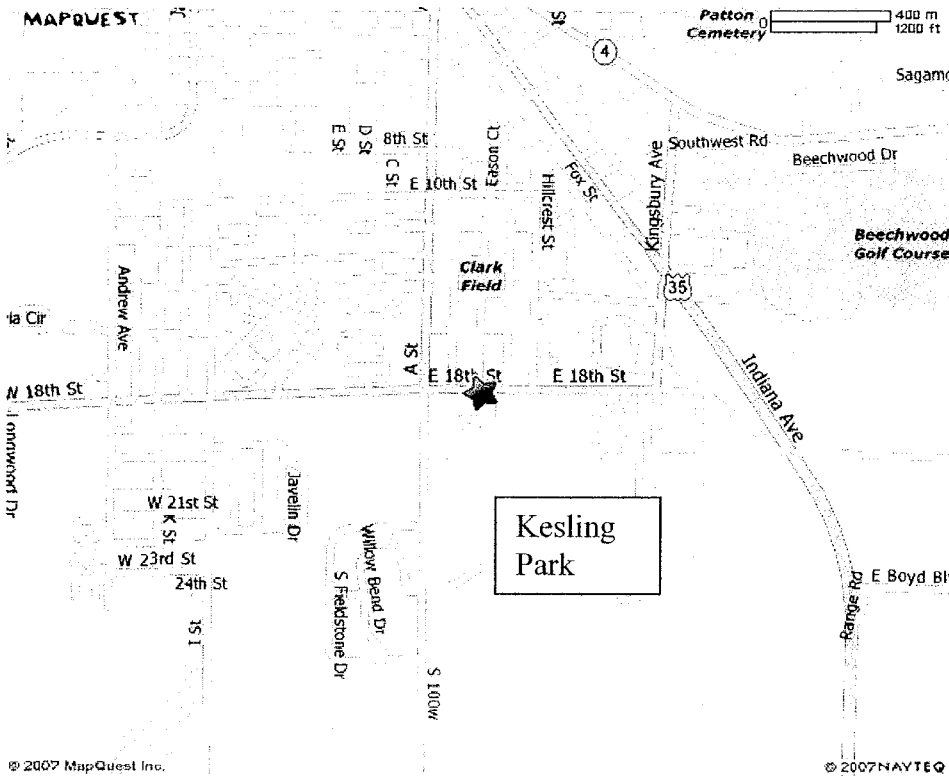

Kesling Park is ¼ mile South of the school. Enter the park from "A" Street.

Go past the high school soccer field, and past the playground. Park in the lot on the right, by the large picnic shelter, (before the softball diamonds).

The U12 field is North of the parking lot

The U8/U10 field is South of the parking lot